

# Technical Guide for the Product User

## 1-1/4" SINGLE PIECE REPAIR CARTRIDGE FOR ANGLE COCK

### PRODUCT DESCRIPTION

Cartridge Based Angle Cock (CBAC) allows for ease of repair as all internal parts can be replaced quickly without removing the angle cock from the car piping.

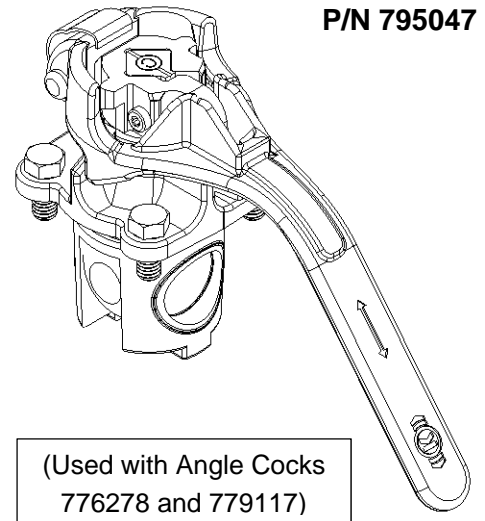
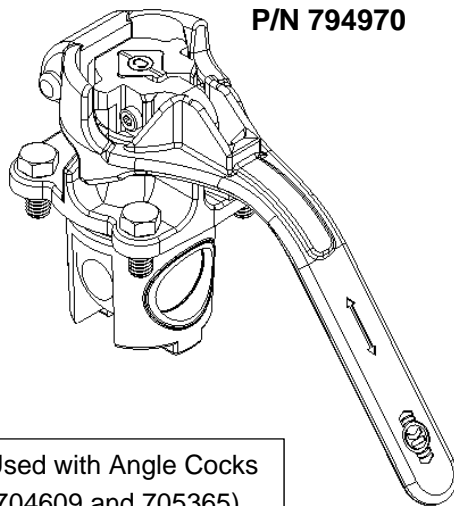

### FEATURES

- One Piece Composite Ball and Key which provides:
  - Corrosion free, non-abrasive, positive sealing surface
  - Reduced time and cost to perform rebuilding due to fewer parts
  - Lighter weight
- Captivated hex head cap screws allow for ease of assembly by eliminating lost screws during installation.
- Ease of maintenance as all internal repairable parts can be replaced without removing the angle cock from the car piping.
- Gripseal end connection provides a leak free seal at temperatures ranging from -50°F to 200°F in addition to the internal standard 1-1/4" pipe thread connection for maximum protection against pull-off.
- Approximate net weight of 3-3/8 lbs

# 1-1/4" SINGLE PIECE REPAIR CARTRIDGE FOR ANGLE COCK

## INSTALLATION INFORMATION

Standard Angle Cock

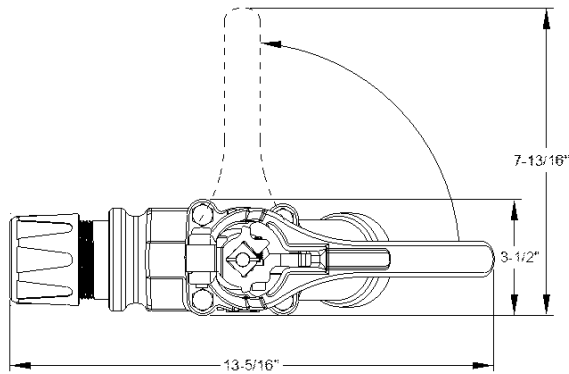

Flanged Angle Cock

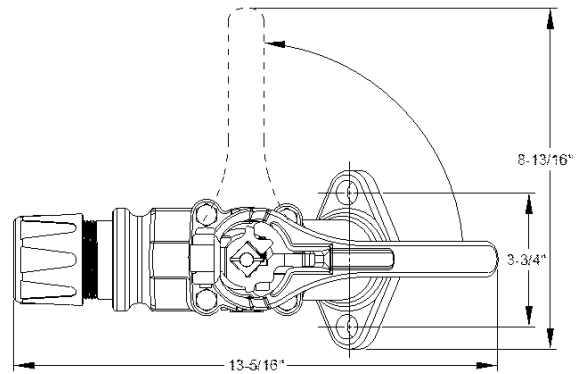

Standard or Flanged Angle Cock

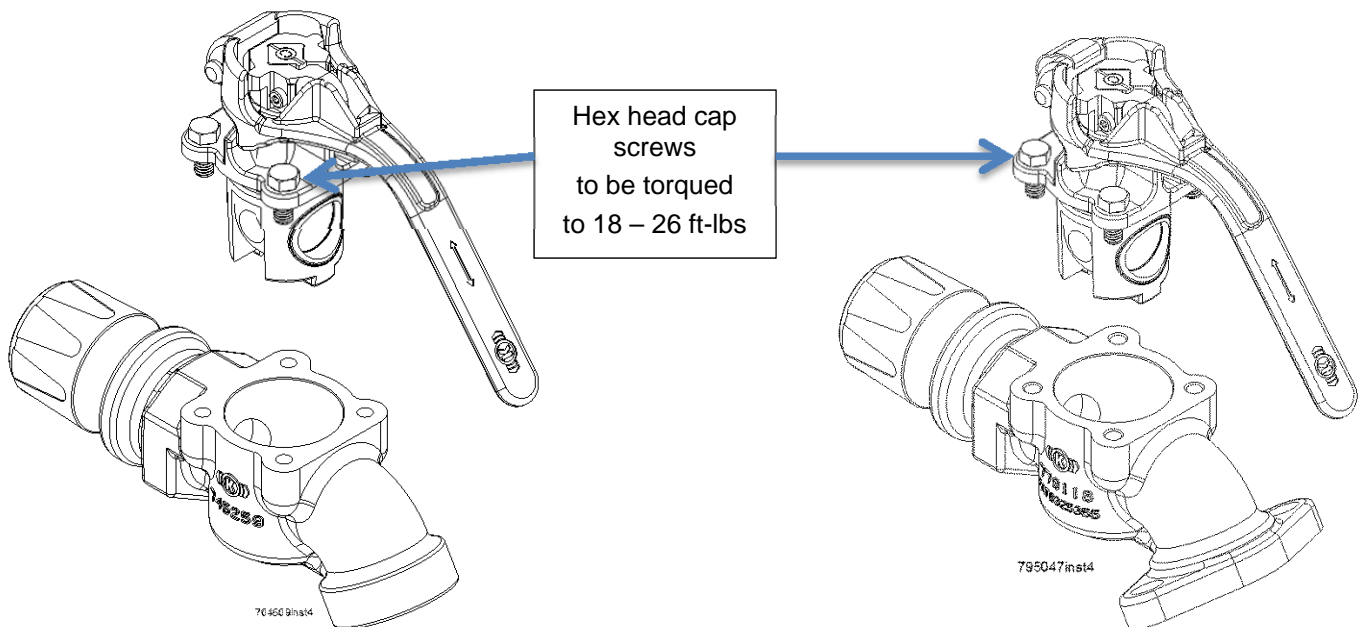
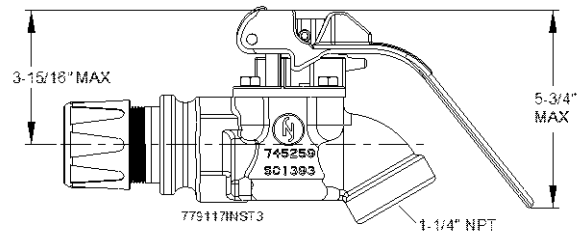

## NEW YORK AIR BRAKE, LLC

www.nyab.com

748 Starbuck Avenue, Watertown, New York 13601

Telephone: 315-786-5200 . 1-888-TEN NYAB

FAX: 315-786-5673 (Engineering)

315-786-5675 (Marketing)

Copyright © NYAB. All rights reserved, including industrial property rights applications. NYAB retains any power of disposal, such as copying and transferring.



Knorr-Bremse Group

TG-57 / April 9, 2019 / Rev.0

Page 2 of 2